

A2
ORIGINAL
PLOT SIZE

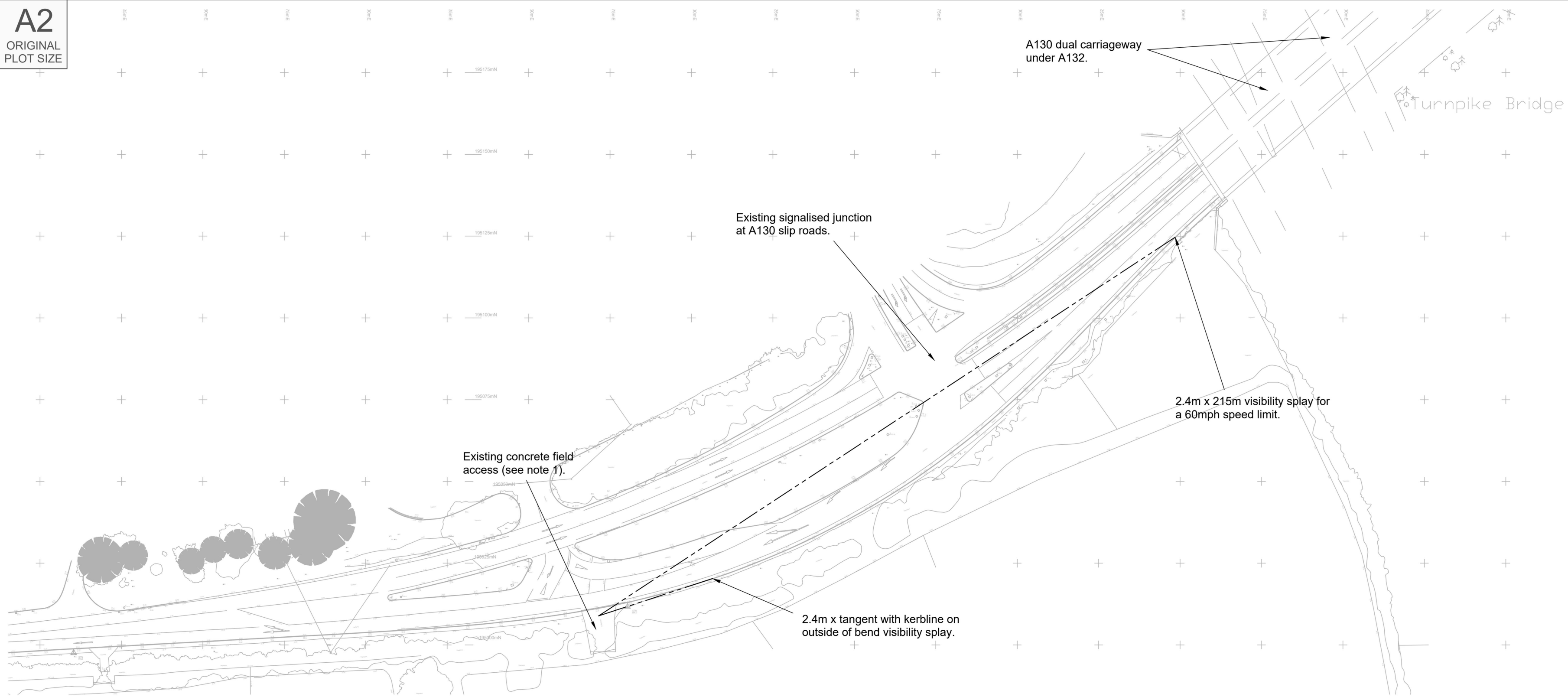

Existing Site Access Arrangement On A132 (Runwell Road)
Scale 1:1,000

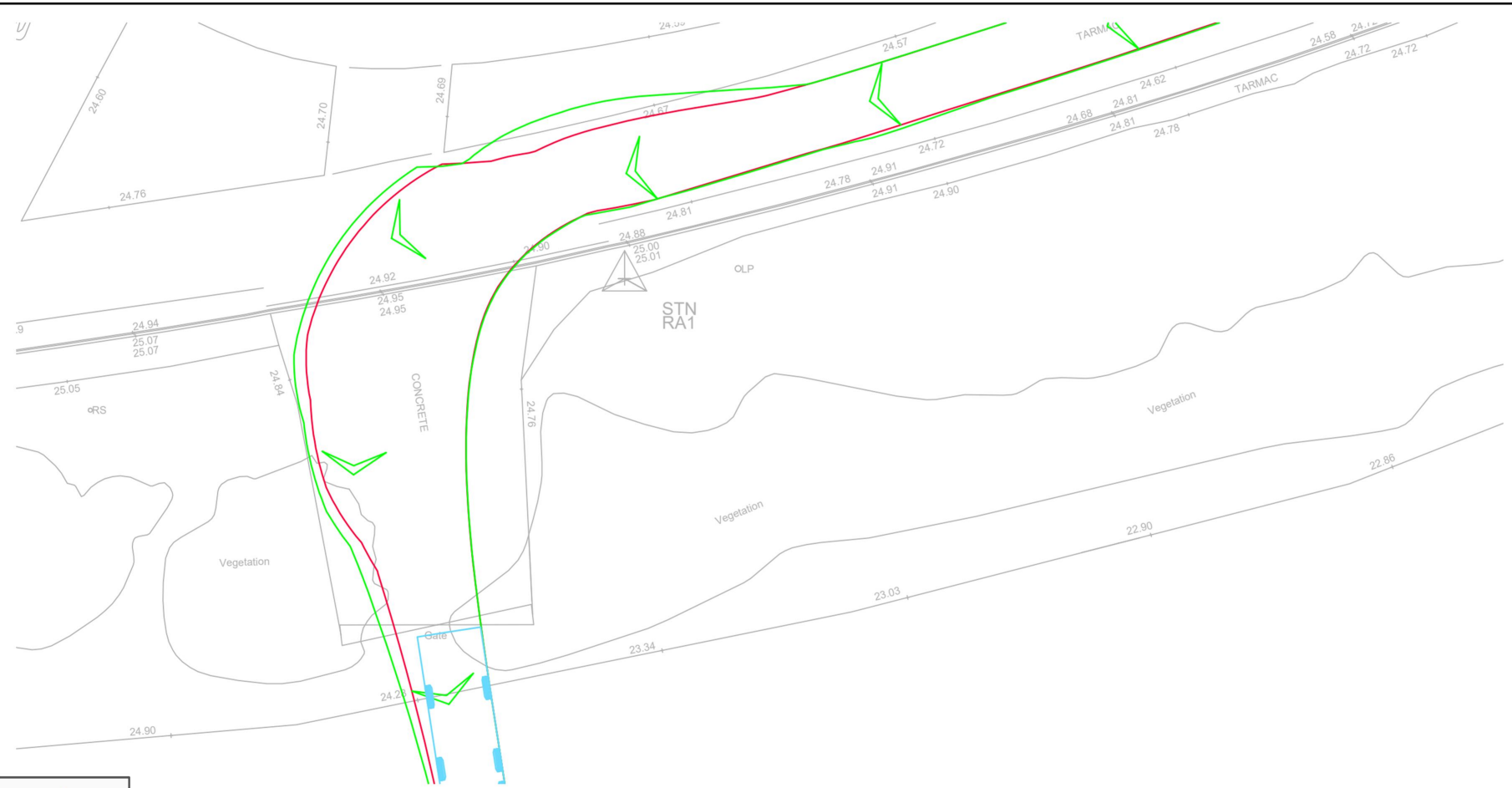

18.55m Longer Semi-trailer Turning Left Into Access
Scale 1:250

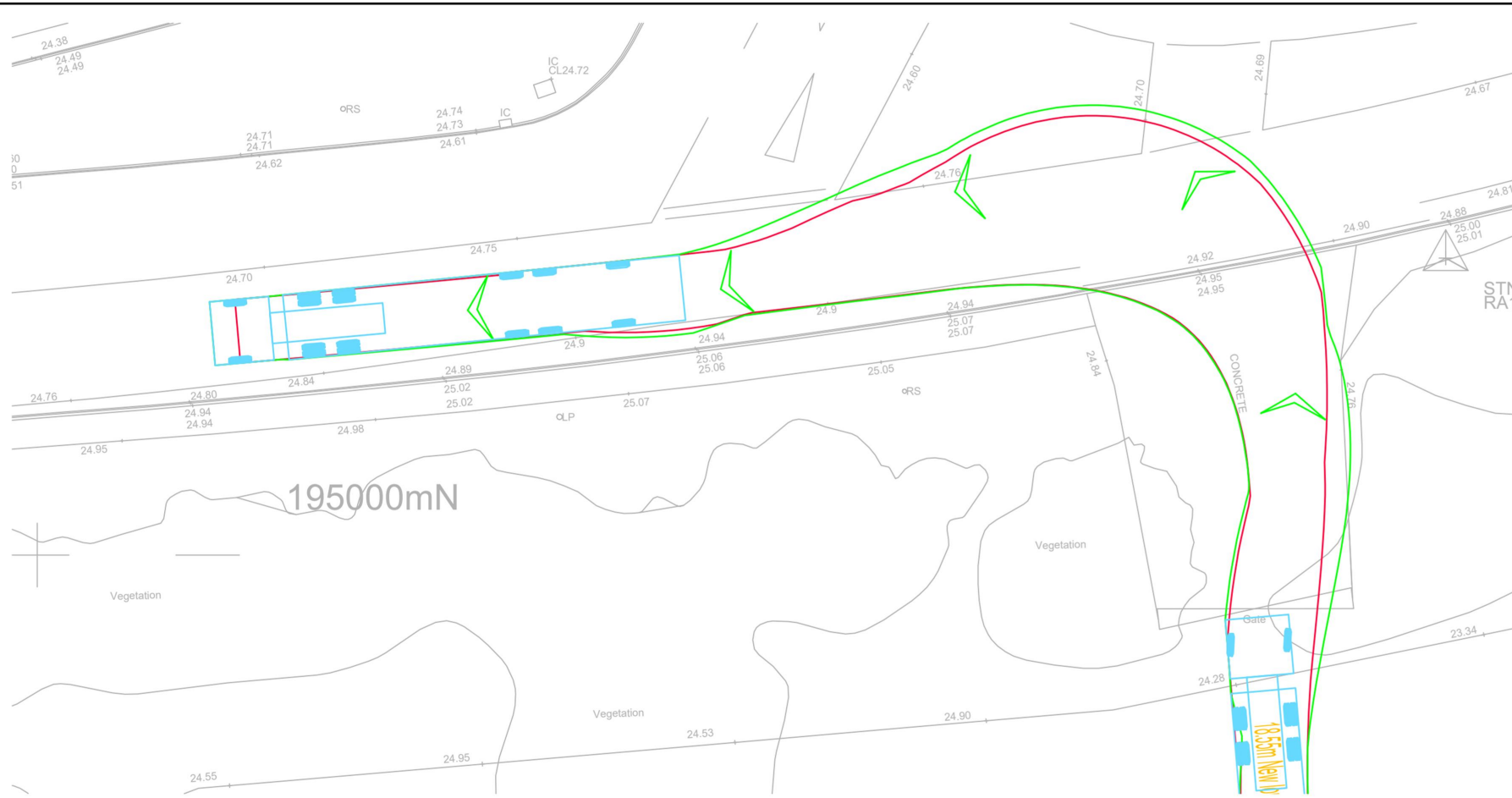

18.55m Longer Semi-trailer Turning Left Out Of Access
Scale 1:250

Reproduced from Ordnance Survey Superplan Data with the permission of The Controller of Her Majesty's Stationary Office. Crown Copyright - Licence No. AL100034021

NOTES:

1. The access will operate as a left in/left out access only.
2. The existing posted speed limit is National Speed Limit.

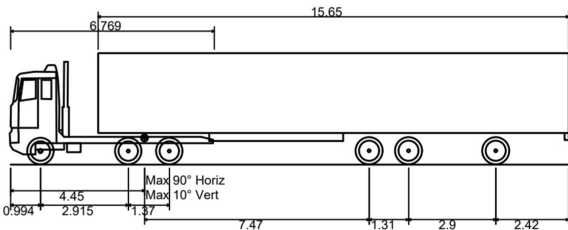

18.55m New longer Semi-trailer Volvo/Muldoon
Overall Length 18.550m
Overall Width 2.550m
Overall Body Height 3.693m
Min Body Ground Clearance 0.331m
Max Track Width 2.550m
Lock to lock time 4.00s
Kerb to Kerb Turning Radius 7.450m

Rev	Date	Details	Drawn by	Checked by	Approved by
-	-		-	-	-

Bristol
Cambridge
London
Manchester
Oxford
Welwyn Garden City



25 King Street
Bristol
BS1 4PB
0117 925 9400

www.tpa.uk.com

CLIENT:
ENSO GREEN HOLDINGS J LIMITED

PROJECT:
SOUTHLANDS SOLAR
FARM

TITLE:
Proposed Site Access
Arrangement On A132 At
Existing Field Access

STATUS:
INFORMATION

SCALE: As Shown	DATE: 10.10.23	DRAWN: KVT	CHECKED: RR	APPROVED: JD
JOB NO: 2201-018	DRAWING NO: SK03	REVISION: -		



RESERVED COPYRIGHT